



TOUCH PANEL

- Innovative "Touch LCD" technology.
- 5 fan channels.
- Supports 25W per channel.
- 2 x USB3.0/Mic & Headphone.
- Switch between Celsius and Fahrenheit.
- Overheating alarm temperature warning.



BACKLIGHT COLORS

7-Color LED including light off function.

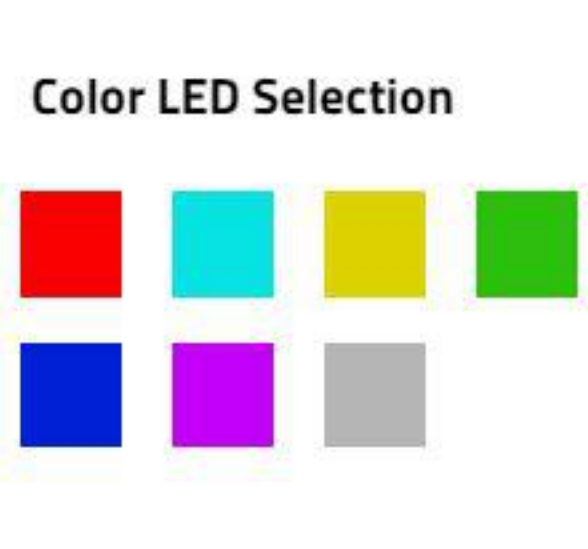

FUNCTIONS

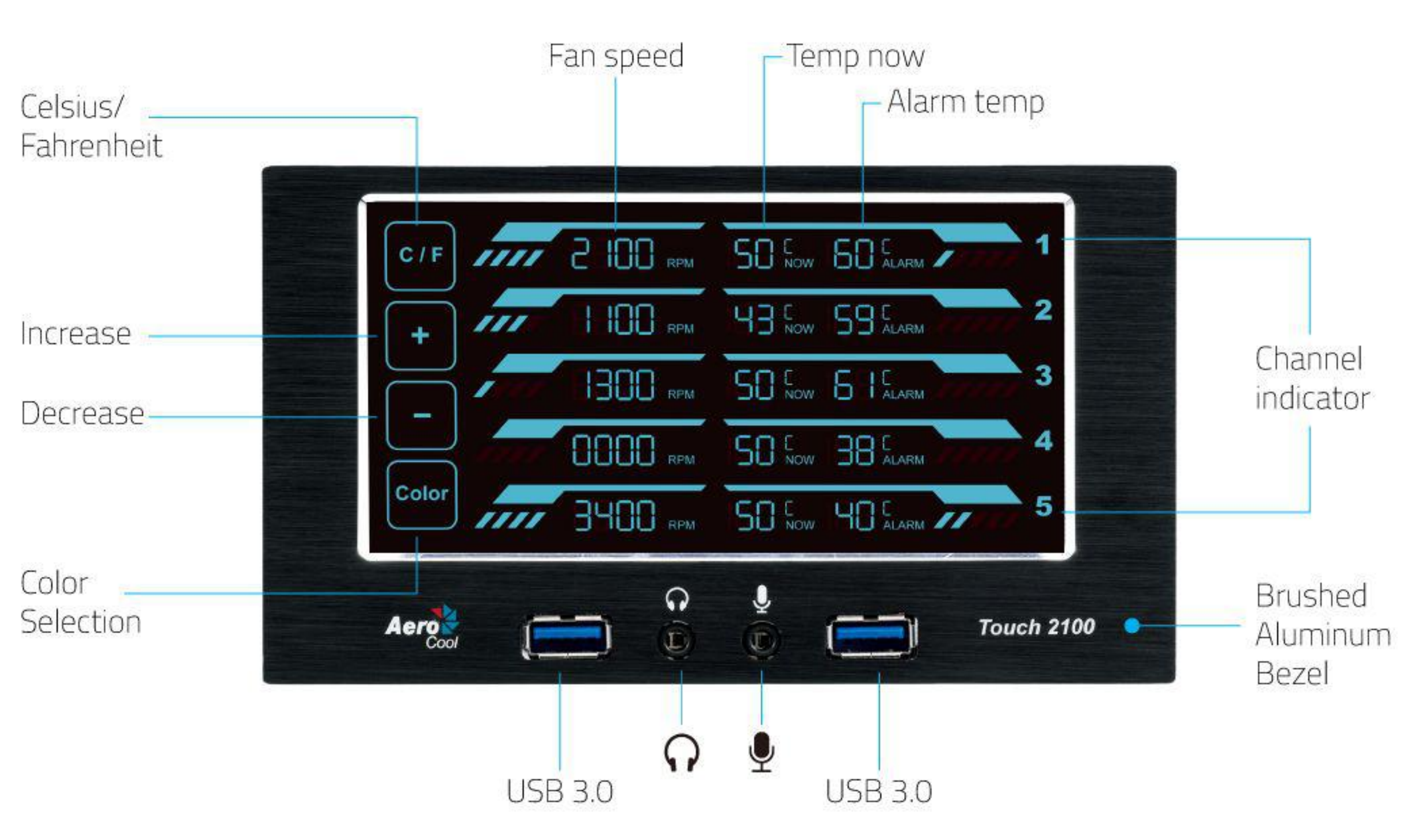

CABLE CONNECTION

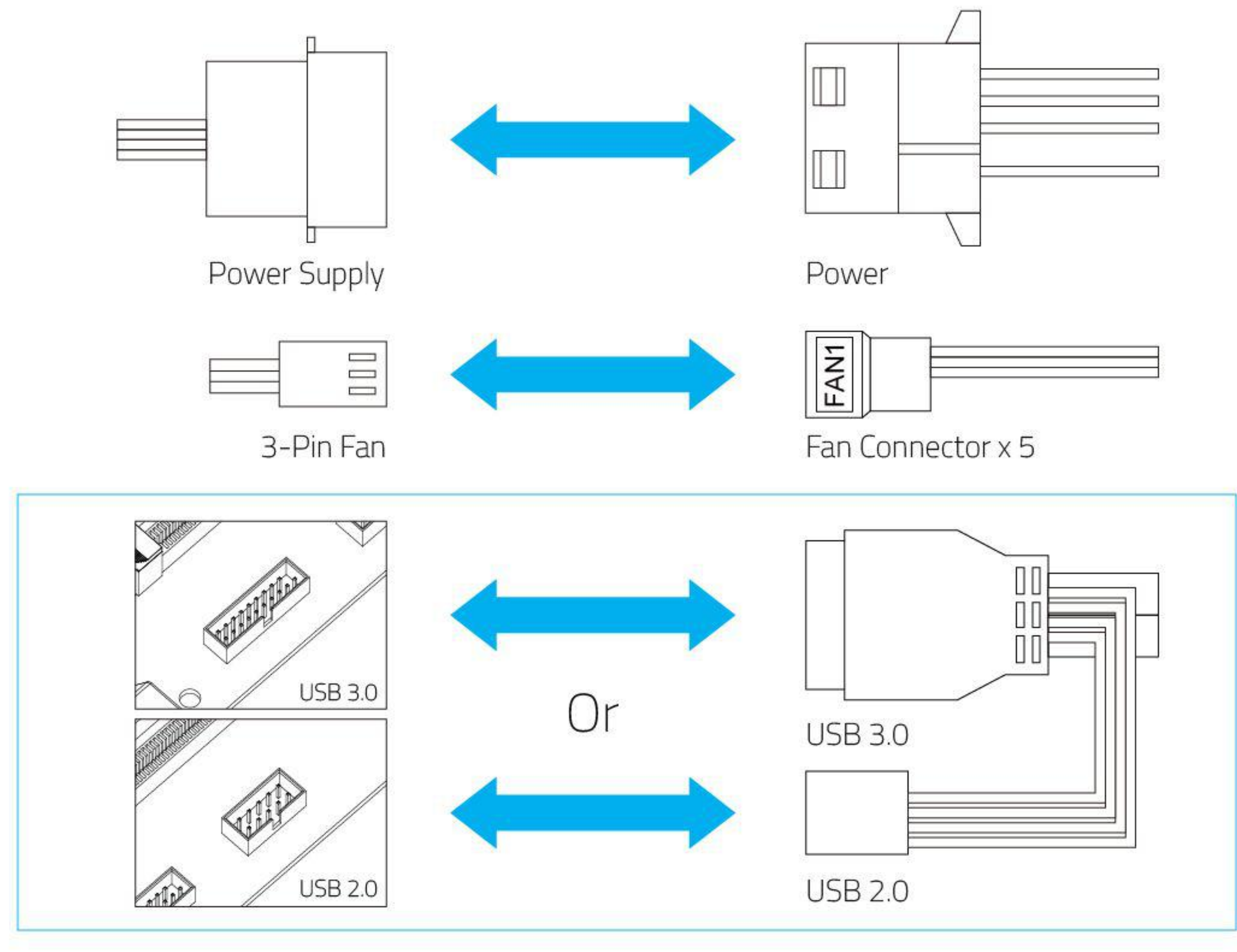

GALLERY



SPECIFICATION

Model Name	Touch-2100
Product Dimension	150(W) x 85(H) x 70(D) mm
Box Dimension	215(W) x 90(H) x 170(D) mm
Net Weight	485g
Gross Weight	670g (Retail box included)
LCD viewable area	113 (W) x 57 (H) mm
Material	Brushed aluminum front bezel w/ steel bracket
Speed Range	0-50%, 55%-100%
Max. wattage per fan channel	20W
I/O Port	2 x USB3.0, Mic & Headphone
Accessories	Screw x 8 (M3x5) / sensor sticker x 10 / spare sensor cable x 2 / spare fan cable x 2
Connectors	5 x 3-pin connectors / 5 x heat sensors

DOWNLOAD

User Manual

DOWNLOAD

REVIEWS & AWARDS

